

4. ST16中后桥(4.42)/ST16 Rear Axles

序号/ No.	名 称 / Designation		页 码 / Page No.
4.01	ST16中桥驱动装置/1st Rear Axle Drive	-----	1
4.02	ST16后桥驱动装置/Rear Axle Drive	-----	8
4.03	ST16中桥桥壳/1st Rear Axle Housing	-----	12
4.04	ST16后桥桥壳/ Rear Axle Housing	-----	14
4.05	ST16后桥轮辋及制动器/Driving axle rim and brake	-----	16

4.01 中桥驱动装置/1st Rear Axle Drive

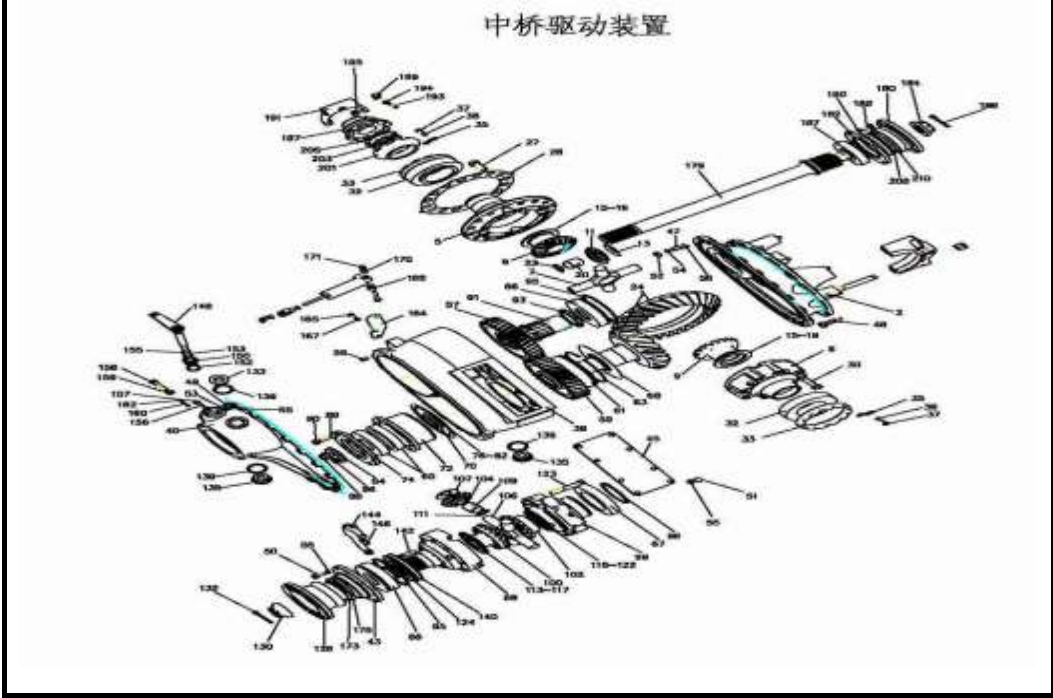

4.01 中桥驱动装置/1st Rear Axle Drive

序号 No.	零部件图号 Part No.	名称	Part Name	数量 Qty	备注 Remark
	AH71131402271	ST16双桥 (4. 42, XS Φ180)	Rear axle ass.	1	
0	AH71131546271	ST16中桥 (4. 42, XS φ180)	1st rear axle ass.	1	
1	AZ9231320714	中桥中段 (i=4. 42, XS φ180)	1st rear axle drive ass.	1	
2	WG9014320120	主减速器壳 (中桥)	Housing of rear driver	1	
4	AZ9231320272	差速器壳	Diff. housing	1	
5	AZ9231320163	差速器壳 (左)	Diff. housing	1	
6	AZ9231320164	差速器壳 (右)	Diff. housing	1	
7	AZ9231320150	十字轴	Spider	1	
9	WG9231320151	半轴齿轮	Gear	2	
11	WG9231320152	行星齿轮	Gear	4	
13	WG9231320153	行星齿轮垫片	Sheet	4	
15	AZ9231320154	调整垫片	Shim	1	
16	AZ9231320155	调整垫片	Shim	1	
17	AZ9231320156	调整垫片	Shim	1	
18	AZ9231320157	调整垫片	Shim	1	
19	AZ9231320158	调整垫片	Shim	1	
20	WG9231320159	衬套	Bush	4	
22	WG9231320160	衬套挡圈	Ring	4	
24	WG9114320251	锥齿轮副 28/17	Pinion and crown wheel	1	
27	Q151B1635TF2	六角头螺栓	Screw	16	
28	WG9114320003	锁片-从动锥齿轮螺栓	Screw	1	
30	WG9231320169	六角头螺栓	Screw	8	

4.01 中桥驱动装置/1st Rear Axle Drive

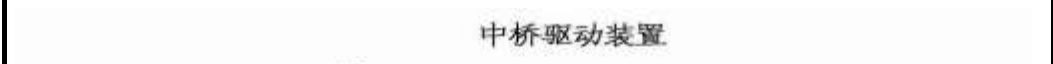

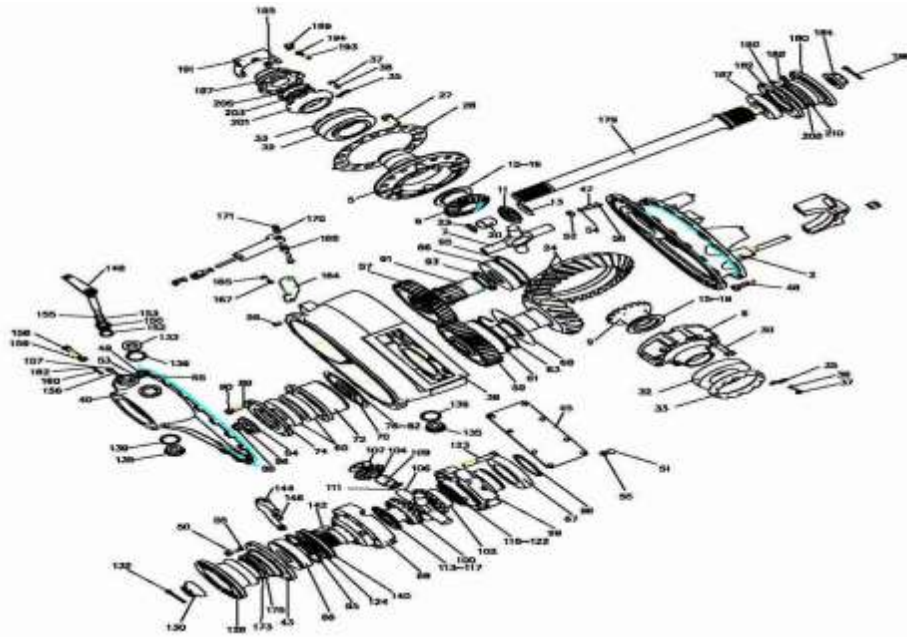

4.01 中桥驱动装置/1st Rear Axle Drive

序号 No.	零部件图号 Part No.	名称	Part Name	数量 Qty	备注 Remark
32	190003326148	圆锥滚子轴承	Roller bearing	2	
33	WG3809320159	差速器轴承调整螺母	Nut	2	
35	WG79000320027	止动片	Safety clip	2	
37	Q150B0816	六角头螺栓	Screw	2	
38	Q40308	弹簧垫圈	Spring washer	2	
39	AZ9231320259	过桥箱	Housing	1	
40	AZ9231320264	过桥箱盖	Housing cap	1	
43	WG9014320175	端盖	Cover	1	
45	WG9014320118	接油板总成	Plate	1	
47	190003813628	双头螺柱	Stud	14	
48	Q1201225F3	双头螺柱	Stud	4	
49	Q1201028F3	双头螺柱	Stud	18	
50	Q150B1025	六角头螺栓	Screw	8	
51	Q150B1020Q	六角头螺栓	Screw	8	
52	Q340B12	I型六角头螺母	Nut	18	
53	Q340B10	六角螺母	Nut	18	
54	Q40312	弹簧垫圈	Spring washer	18	
55	Q40310	弹簧垫圈	Spring washer	34	
56	Q5211016	圆柱销	Cylinder pin	4	
57	WG9214320002	主动圆柱齿轮z=35	Drive gear	1	

4.01 中桥驱动装置/1st Rear Axle Drive

中桥驱动装置



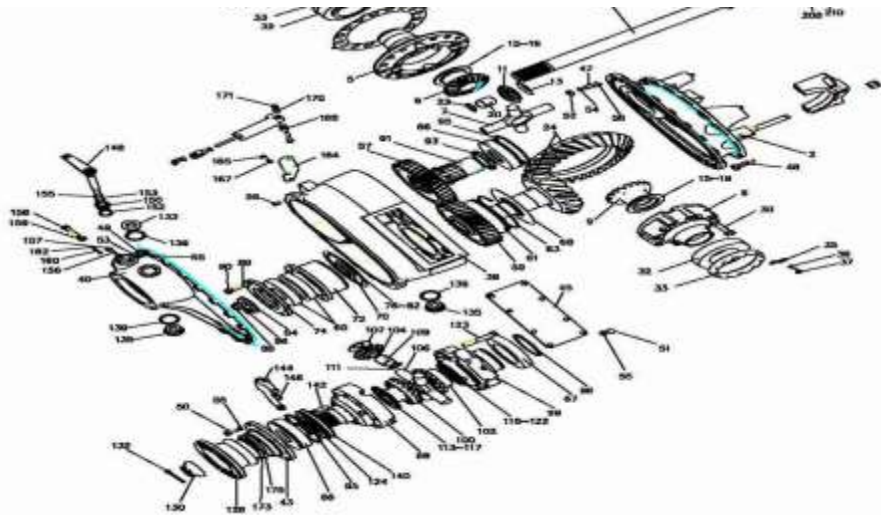

4.01 中桥驱动装置/1st Rear Axle Drive

序号	零部件图号	名称	Part Name	数量	备注
No.	Part No.			Qty	Remark
59	WG9114320001	从动圆柱齿轮 $z=27$	Driven gear	1	
61	WG9014320257	滚柱轴承	Roller bearing	1	
63	WG9014320256	钢丝档圈	Snap ring	1	
65	190003326333	圆锥滚子轴承	Roller bearing	2	
66	190003311543	有止动槽的向心球轴承	Bearing	2	
67	190003310239	带防尘盖深沟球轴承	Ball bearing	1	
68	WG9014320174	挡油片	Plate	1	
70	WG9014320140	隔圈	Ring	1	
72	WG9014320129	轴承座	Bearing seat	1	
74	WG9014320128	轴承外环压板	Plate	1	
76	WG9014320131	调整垫片	Shim	1	
78	WG9014320132	调整垫片	Shim	1	
80	WG9014320133	调整垫片	Shim	1	
82	WG9014320134	调整垫片	Shim	1	
84	WG780 320088	轴承压板	Plate	1	
86	WG9114320002	防松锁片	Locking sheet	1	
88	Q150B1430TF2	六角头螺栓	Screw	3	
89	190003813543	双头螺栓	Stud	8	
90	Q33210	六角锁紧螺母	Nut	8	
91	WG9014320135	空心轴	Hollow shaft	1	

4.01 中桥驱动装置/1st Rear Axle Drive

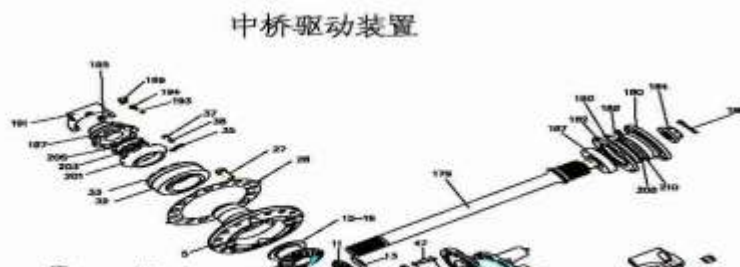

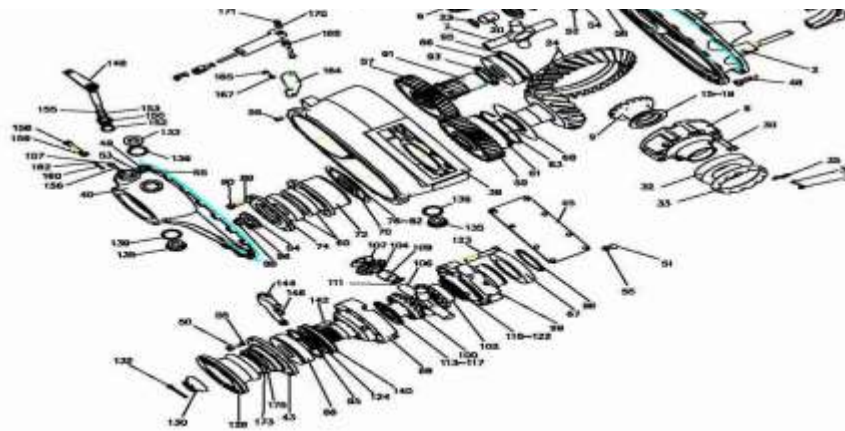

4.01 中桥驱动装置/1st Rear Axle Drive

序号	零部件图号	名称	Part Name	数量	备注
No.	Part No.			Qty	Remark
93	WG9012250031	开槽园螺母	Nut	1	
95	Q433130	轴用压扁钢丝挡圈	Snap ring	2	
96	190003933580	轴用弹性挡圈	Circlip	1	
97	AZ9231320271	差速器壳	Diff. housing	1	
98	AZ9231320068	差速器壳（前）	Diff. housing	1	
99	AZ9231320069	差速器壳（后）	Diff. housing	1	
100	WG9231320225	前半轴齿轮	Gear	1	
102	WG9231320226	后半轴齿轮	Gear	1	
104	WG9231320227	行星齿轮	Gear	4	
106	AZ9231320223	十字轴	Spider	1	
107	WG9231320224	行星齿轮垫片	Sheet	4	
109	WG9231320221	衬套	Bush	4	
111	WG9231320222	衬套挡圈	Ring	4	
113	AZ9231320091	半轴齿轮（前）垫片	Shim	1	
114	AZ9231320092	半轴齿轮（前）垫片	Shim	1	
115	AZ9231320093	半轴齿轮（前）垫片	Shim	1	
116	AZ9231320094	半轴齿轮（前）垫片	Shim	1	
117	AZ9231320095	半轴齿轮（前）垫片	Shim	1	
118	AZ9231320096	半轴齿轮(后)垫片	Shim	1	
119	AZ9231320097	半轴齿轮(后)垫片	Shim	1	

4.01 中桥驱动装置/1st Rear Axle Drive



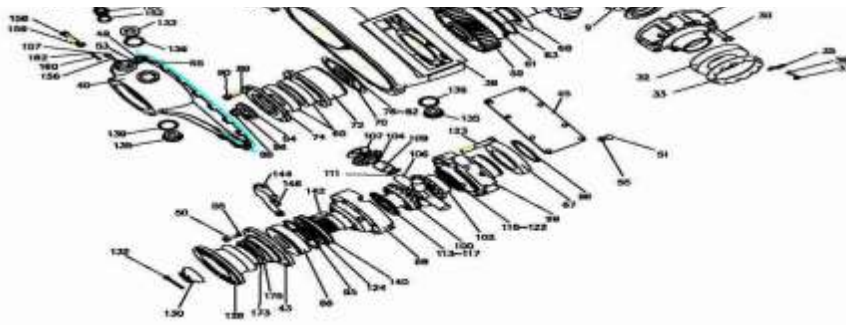

4.01 中桥驱动装置/1st Rear Axle Drive

序号	零部件图号	名称	Part Name	数量	备注
No.	Part No.			Qty	Remark
120	AZ9231320098	半轴齿轮(后)垫片	Shim	1	
121	AZ9231320099	半轴齿轮(后)垫片	Shim	1	
122	AZ9231320100	半轴齿轮(后)垫片	Shim	1	
123	Q151C1280TF2	六角头螺栓	Screw	12	
124	WG9014320061	轴间差速器壳垫片	Shim	1	
126	AZ9231320014	XS φ 180凸缘总成	Flange ass.	1	
130	WG79000320013	凸缘螺母	Nut	1	
132	Q5005055	开口销	Split pin	1	
133	WG81500010163	螺塞	Plug	1	
135	1586 33 15	磁性螺塞总成	Magnet plug	2	
139	Q72336	密封垫圈	Washer	3	
140	WG288 320105	差速锁锁环	Ring	1	
142	WG288 320106	差速锁销	Pin	10	
144	WG9014320053	拨叉	Fork	1	
146	WG1800 320077	拨叉活动块	Block	2	
148	WG9014320076	差速锁摇臂总成	Rocker ass.	1	
150	WG2700 320037	衬套	Bush	1	
152	AZ9231320038	O形圈	O-ring	1	
153	WG288 730062	O型密封圈	O-ring	1	
155	190003933072	轴用弹性档圈	Circlip	1	

4.01 中桥驱动装置/1st Rear Axle Drive

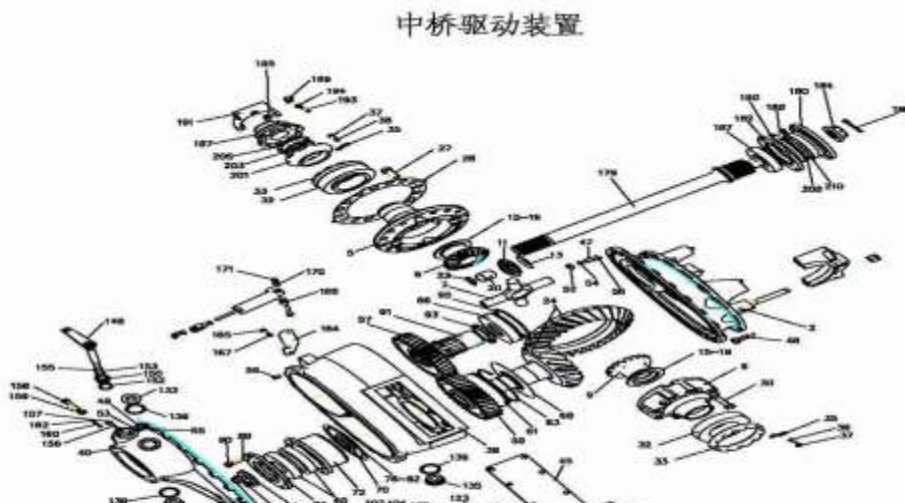

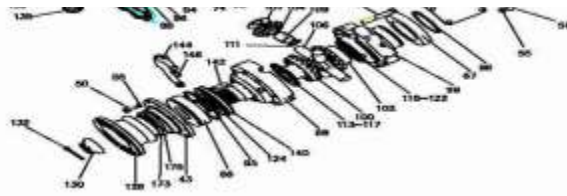

4.01 中桥驱动装置/1st Rear Axle Drive

序号 No.	零部件图号 Part No.	名称	Part Name	数量 Qty	备注 Remark
156	190003902070	开槽长园柱端紧定螺钉	Screw	1	
158	Q150B1050Q	六角头螺栓	Screw	1	
159	Q340B10	六角螺母	Nut	1	
160	WG69000330008	销	Shaft	1	
162	Q43705	轴用钢丝挡圈	Circlip	1	
163	AZ9231320262	托架总成	Bracket ass.	1	
165	Q150B0865	六角头螺栓	Screw	1	
166	Q150B0818	六角头螺栓	Screw	2	
167	Q40308	弹簧垫圈	Spring washer	2	
168	WG61000060072	隔套	Spacer	1	
170	Q40108	平垫圈	Washer	1	
171	Q33208	六角锁紧螺母	Nut	1	
173	190003070026	轴密封圈	Gasket	1	
175	190003078772	轴密封圈	Gasket	1	
179	AZ9231320261	贯通轴	Driving shaft	1	
180	WG9231320205	Φ165输出凸缘总成	Flange ass.	1	
182	WG9231320141	轴承座	Bearing seat	1	
184	WG79000320013	凸缘螺母	Nut	1	
186	Q5005055	开口销	Split pin	1	
187	WG9231326212	双列圆锥滚子轴承	Roller bearing	1	

4.01 中桥驱动装置/1st Rear Axle Drive

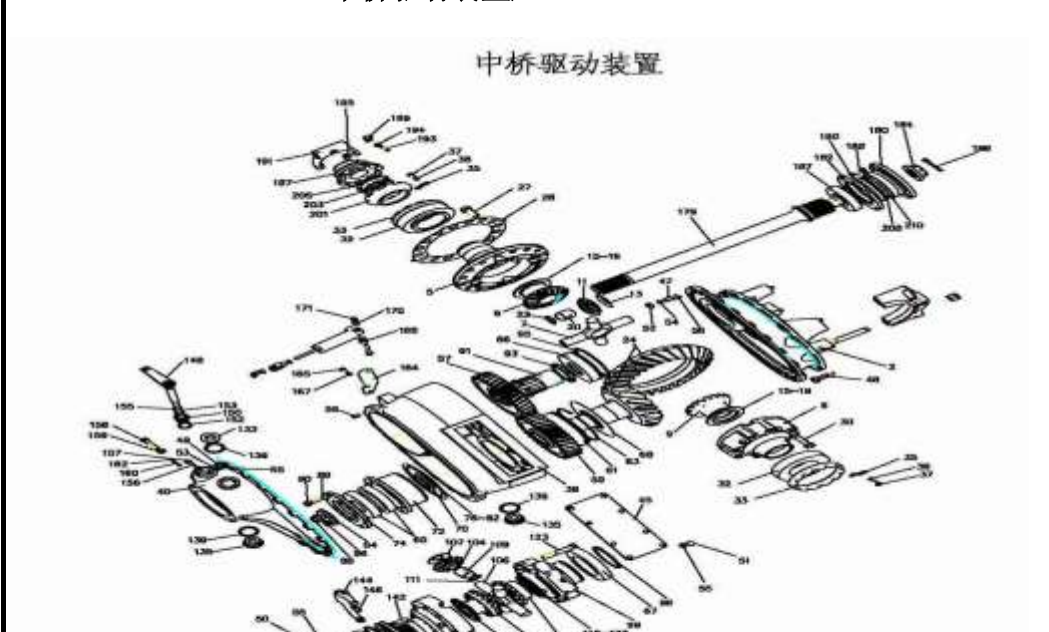

4.02 后桥驱动装置/Rear Axle Drive					
序号	零部件图号	名称	Part Name	数量	备注
No.	Part No.			Qty	Remark
0	AH71131552272	ST16后桥(4.42, φ1650)	rear axle ass.	1	
1	AZ9231320701	后桥中段(i=4.42, φ165)	rear axle drive ass.	1	
2	199012320098	主减速器壳	Rear driver housing	1	
10	WG9012320131	轴承座	Bearing seat	1	
12	WG9012320173	调整垫片	Shim	1	
14	WG9012320174	调整垫片	Shim	1	
16	WG9012320175	调整垫片	Shim	1	
18	WG9012320176	调整垫片	Shim	1	
20	Q150B1230TF2	六角头螺栓	Stud	12	
21	WG9012320133	密封圈	Washer	1	
23	AZ9231320274	差速器壳	Diff. housing	1	
24	AZ9231320168	差速器壳(左)	Diff. housing	1	
25	AZ9231320164	差速器壳(右)	Diff. housing	1	
26	190003326148	圆锥滚子轴承	Roller bearing	2	
27	AZ9231320150	十字轴	Spider	1	
29	WG9231320151	半轴齿轮	Gear	2	
31	WG9231320152	行星齿轮	Gear	4	
33	WG9231320153	行星齿轮垫片	Joint	4	
35	AZ9231320154	调整垫片	Shim	1	
36	AZ9231320155	调整垫片	Shim	1	
37	AZ9231320156	调整垫片	Shim	1	

4.02 后桥驱动装置/Rear Axle Drive

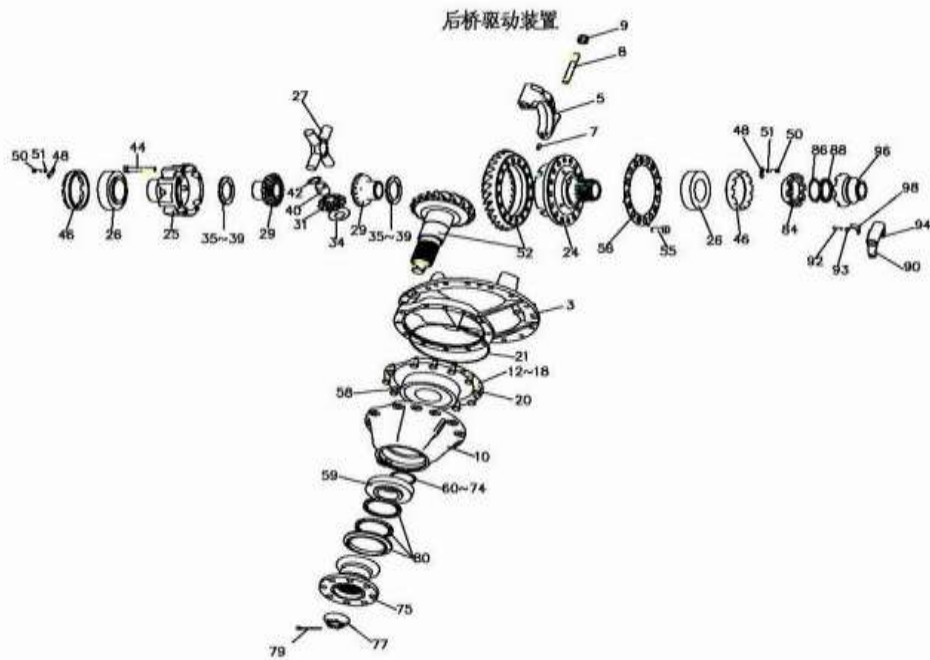

4.02 后桥驱动装置/Rear Axle Drive

序号	零部件图号	名称	Part Name	数量	备注
----	-------	----	-----------	----	----

No.	Part No.	名称	Part Name	Qty	Remark
38	AZ9231320157	调整垫片	Shim	1	
39	AZ9231320158	调整垫片	Shim	1	
40	WG9231320159	衬套	Bush	4	
42	WG9231320160	衬套挡圈	Ring	4	
44	WG9231320169	六角头螺栓	nut	8	
46	WG3809320159	差速器轴承调整螺母	nut	2	
48	WG79000320027	止动片	Safety clip	2	
50	Q150B0816	六角头螺栓	nut	2	
51	Q40308	弹簧垫圈	Spring washer	2	
52	AZ9231320911	锥齿轮付 33/26	Pinion and crown wheel	1	
55	Q151B1632TF2	六角头螺栓	nut	16	
56	WG9114320003	锁片-从动锥齿轮螺栓	Screw	1	
58	190003326546	圆锥滚子轴承	Roller bearing	1	
59	190003326236	圆锥滚子轴承	Roller bearing	1	
60	WG880 320002	调整垫片	Shim	1	
62	1880 320003	调整垫片	Shim	1	
63	1880 320004	调整垫片	Shim	1	
64	1880 320005	调整垫片	Shim	1	
65	1880 320006	调整垫片	Shim	1	
66	1880 320007	调整垫片	Shim	1	

4.02 后桥驱动装置/Rear Axle Drive

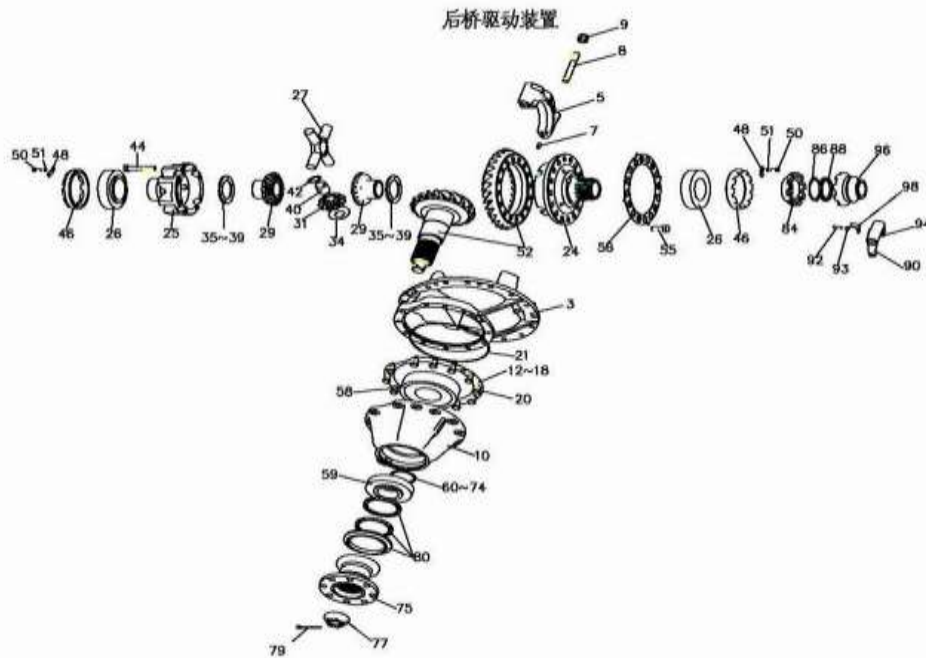

4.02 后桥驱动装置/Rear Axle Drive

序号	零部件图号	名称	Part Name	数量	备注
No.	Part No.			Qty	Remark
67	1880 320008	调整垫片	Shim	1	
68	1880 320009	调整垫片	Shim	1	

69	1880 320010	调整垫片	Shim	1	
70	1880 320011	调整垫片	Shim	1	
71	1880 320012	调整垫片	Shim	1	
72	1880 320013	调整垫片	Shim	1	
73	1880 320014	调整垫片	Shim	1	
74	1880 320015	调整垫片	Shim	1	
75	WG9231320110	Φ165凸缘总成	Flange ass.	1	
77	WG79000320013	凸缘螺母	nut	1	
79	Q5005055	开口销	Split pin	1	
80	WG9231320001	主减油封总成	Sealing ass.	1	
82	WG3809320155	固定啮合套	Shifting dog	1	
84	WG3809320158	锁止垫片	Locking sheet	1	
86	WG3809320157	园螺母	Nut	1	
88	WG9012320014	拨叉	Fork	1	
90	Q2800825	开槽锥端紧定螺钉	Screw	1	
91	Q340B08	1型六角螺母	Nut	1	
92	WG1800 320077	拨叉活动块	Block	2	
94	WG3809320156	滑动啮合套	Sliding shifting sleeve	1	

4.02 后桥驱动装置/Rear Axle Drive

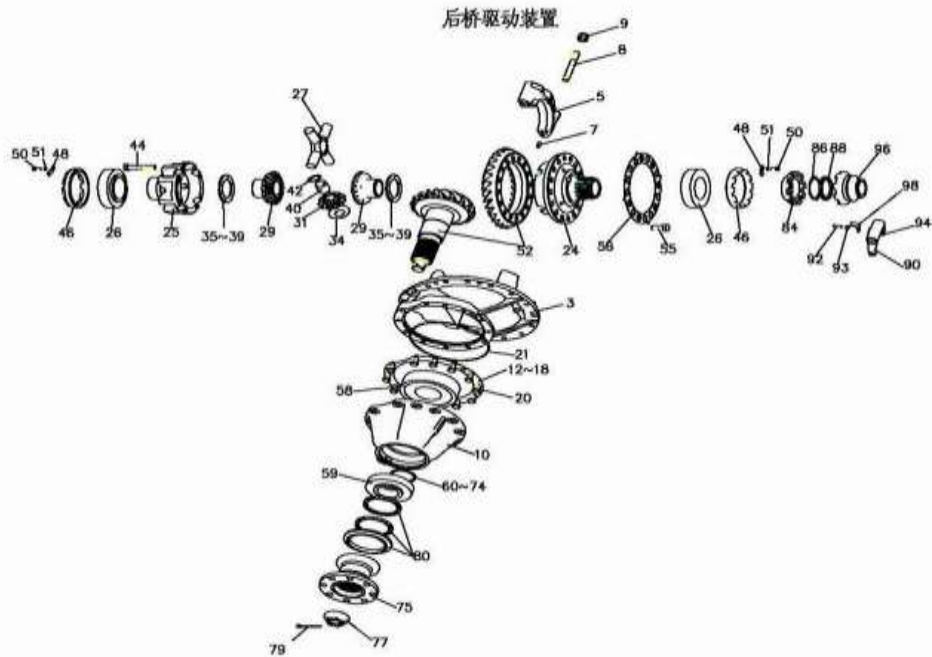

4.02 后桥驱动装置/Rear Axle Drive

序号	零部件图号	名称	Part Name	数量	备注
No.	Part No.			Qty	Remark
96	WG901232002	弯板	Angle plate	1	
100	190003904529	标牌铆钉--铆钉	Rivet	2	

42	WG9231330106	橡胶软管	Hosepipe	1	
44	WG9014330146	弓形固定卡总成(下)	Clip	1	
46	WG9014330147	弓形固定卡总成(上)	Clip	1	
48	Q2540820	十字槽沉头螺钉	Screw	4	
49	190003810631	双头螺柱	Stud	4	
50	190003888457	自锁螺母	nut	16	
51	WG2297Y4835	铭牌	Plug	1	
53	190003904529	标牌铆钉	Rivet	2	
54	WG9014330126	操纵杆总成	Lever ass.	1	
56	1680M 320015	O型垫圈	O-ring	1	
57	WG69000330008	销	pin	1	
59	WG69000330009	销	pin	1	

4.03 中桥桥壳/1st Rear Axle Housing

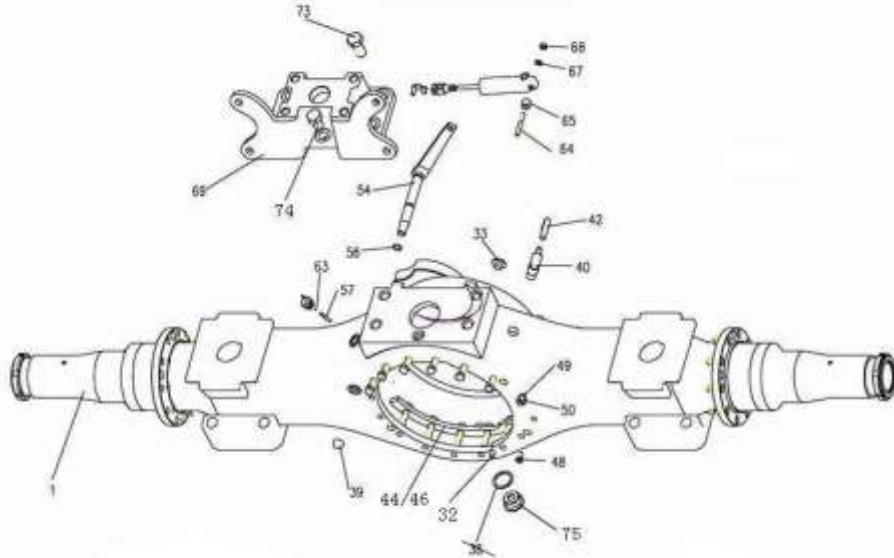

4.03 中桥桥壳/1st Rear Axle Housing

序号	零部件图号	名称	Part Name	数量	备注
No.	Part No.			Qty	Remark
61	WG9100330010	销	Pin	1	
63	Q43705	轴用钢丝挡圈	Snap clip	1	
64	Q1200850F3	双头螺柱	Stud	1	
65	WG61000060084	间隔衬套	Sleeve	1	
67	Q40108	平垫圈	Washer	1	
68	Q33208	2型全金属六角锁紧螺母	Nut	1	
69	WG9231340042	气室支架(中桥)	Bracket	1	
73	Q151B2040TF2	六角头螺栓	Screw	4	
74	Q151B2035TF2	六角头螺栓	Screw	1	
75	WG9231330015	磁性螺塞总成	Magnet plug	1	

4.04 后桥桥壳/ Rear Axle Housing

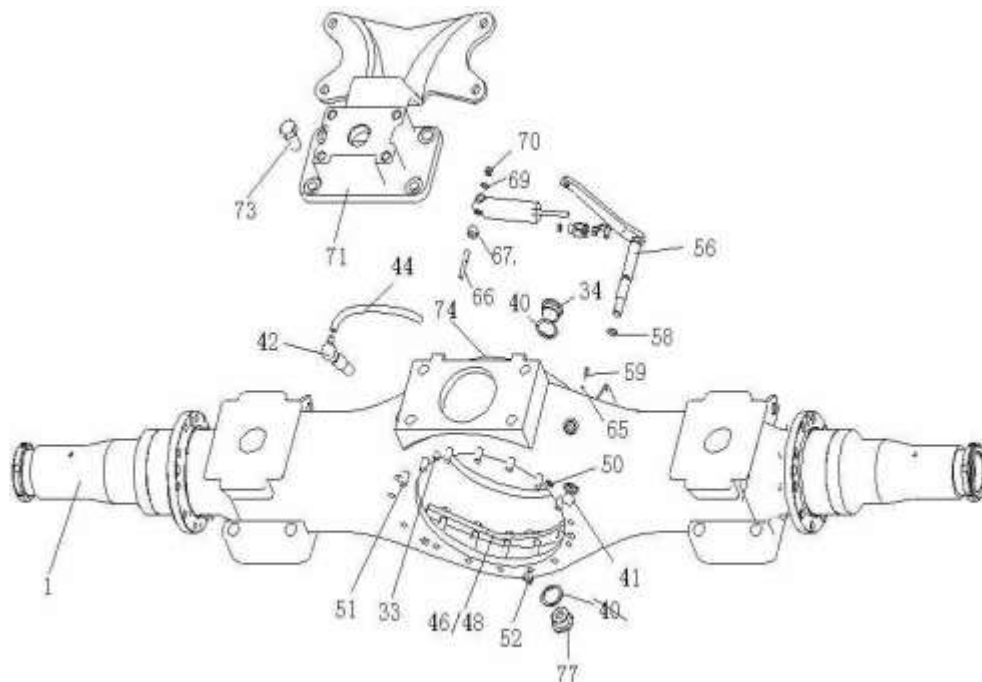

4.04 后桥桥壳/ Rear Axle Housing

序号 No.	零部件图号 Part No.	名称	Part Name	数量 Qty	备注 Remark
1	AZ9231330569	ST16后桥壳总成(轮距1850, 断开式平衡悬架用)	Rear axle housing ass.	1	
30	WG680340013	园螺母	Nut	1	
32	1680 340014	园螺母	Nut	1	
33	Q5211016	园柱销	Cylinder pin	1	
34	WG81500010163	螺塞	Plug	1	
40	Q72336	密封垫圈	Gasket	1	
41	190003989290	碗形堵塞	Croe plug	1	
42	WG9231330105	通气塞	Breather	1	
44	WG9231330106	橡胶软管	Hosepipe	1	
46	WG9014330146	弓形固定卡总成(下)	Clip	1	
48	WG9014330147	弓形固定卡总成(上)	Clip	1	
50	Q2540820	十字槽沉头螺钉	Screw	4	
51	190003810631	双头螺柱	Stud	4	
52	190003888457	自锁螺母	Nut	16	

55	190003904529	标牌铆钉--铆钉	Rivet	2	
56	WG9014330125	操纵杆总成	Lever ass.	1	
58	1680M 320015	O型垫圈	O-ring	1	
59	WG69000330008	销	Pin	1	
61	WG69000330009	销	Pin	1	
63	WG9100330010	销	Pin	1	

4.04 后桥桥壳/ Rear Axle Housing

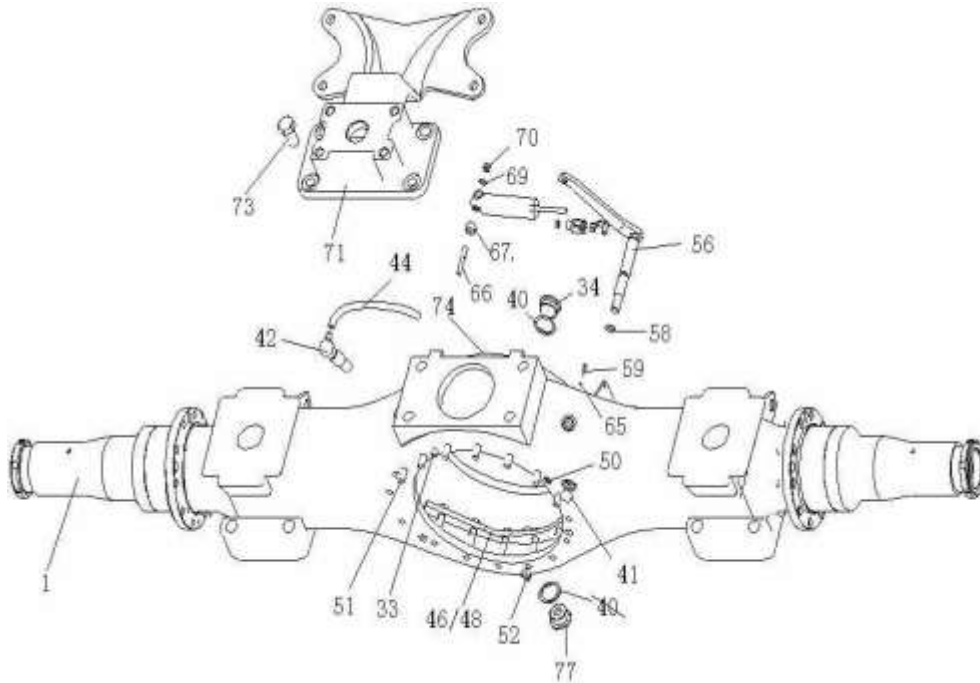

4.04 后桥桥壳/ Rear Axle Housing

序号	零部件图号	名称	Part Name	数量	备注
No.	Part No.			Qty	Remark
65	Q43705	轴用钢丝挡圈	Snap clip	1	
66	Q1200850F3	双头螺柱	Stud	1	
67	WG61000060084	间隔衬套	Sleeve	1	
69	Q40108	平垫圈	Washer	1	
70	Q33208	2型全金属六角锁紧螺母	Nut	1	
71	WG9231340041	气室支架(后桥)	Bracket	1	
73	Q151B2040TF2	六角头螺栓	Screw	4	
74	AZ9231330050	后盖总成	Cover ass.	1	
77	WG9231330015	磁性螺塞总成	Magnet plug	1	

4.05 后桥轮辋及制动器/Driving axle rim and brake

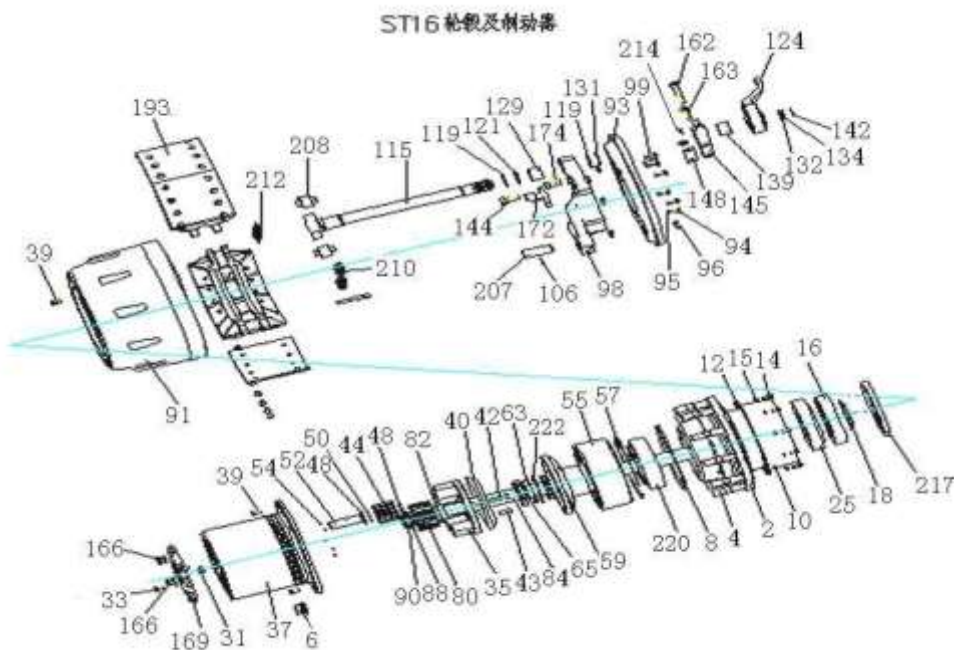

4.05 后桥轮辋及制动器/Driving axle rim and brake

序号 No.	零部件图号 Part No.	名称	Part Name	数量 Qty	备注 Remark
	19911234 0011	后轮毂总成 ABS	Rear wheel hub with ABS	2	Only for Rear axle
1	199112340010	后轮毂总成	Rear wheel hub ass.	2	for 1st Rear axle
2	WG9112340009	后轮毂	Rear wheel hub	4	
4	WG9112340123	车轮螺栓(后)	Screw	40	
6	WG9003884160	车轮螺母	Nut	40	
8	WG9012340029	密封圈	Washer	8	
10	WG9012340021	挡油罩	Oil drip pan	4	
12	WG9012340020	密封垫片	Shim	4	
14	Q150B0816	六角头螺栓	Screw	40	
15	Q40308	弹簧垫圈	Spring washer	40	
16	WG9012340017	隔圈	Ring	4	
18	WG9012340027	密封圈	Washer	4	
25	190003326067	圆锥滚子轴承	Roller bearing	4	
31	WG9012340011	端盖顶销	Bolt	4	
33	Q150B1018	六角头螺栓	Screw	40	
34	199112340029	行星架总成	Planetary carrier ass.	4	
35	199112340018	行星架	Planetary carrier	2	
37	199012340069	轮边减速器壳	housing of Planetary Drive	2	
39	Q2541025	十字槽沉头螺钉	Screw	16	
40	WG880420027	行星架挡油盘	Oil drip pan	4	
42	Q151C1295TF2	六角头螺栓	Screw	20	

4.05 后桥轮辋及制动器/Driving axle rim and brake

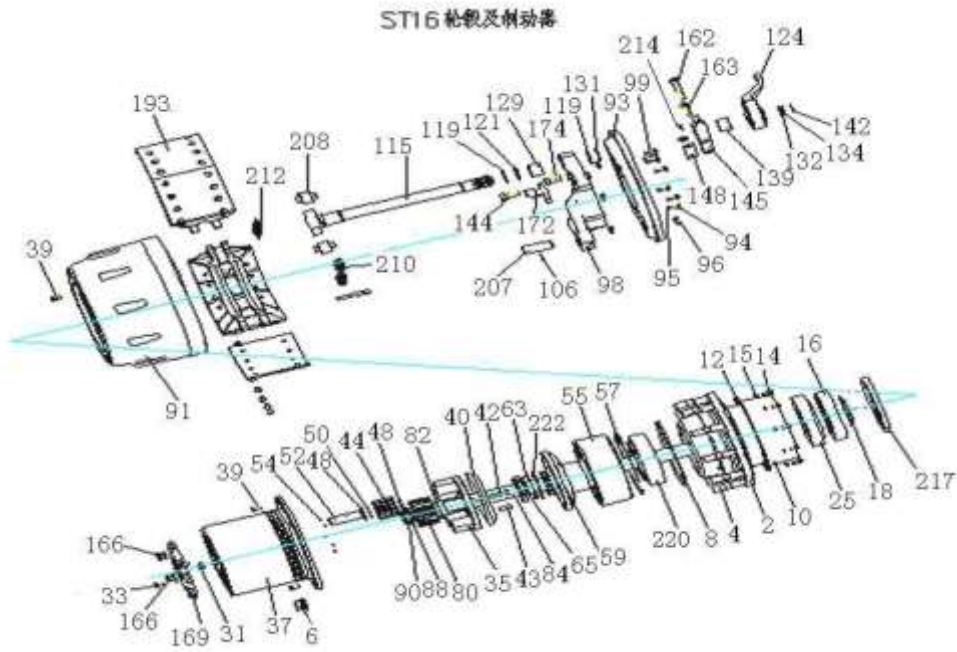

4.05 后桥轮辋及制动器/Driving axle rim and brake

序号	零部件图号	名称	Part Name	数量	备注
No.	Part No.			Qty	Remark
43	190003901704	园柱销	Cylinder pin	20	
44	WG9012340122	行星轮 (Z=16)	Planetary wheel	20	
48	WG9012340075	行星轮垫片	Washer	40	
50	WG9012340077	垫圈	Washer	20	
52	WG9012340004	行星轮轴	Shaft	20	
54	190003330148	钢球	steel ball	20	
55	WG9012340121	内齿圈 (Z=57)	Gear ring	4	
57	WG880420014	轴用挡圈	Snap ring	4	
59	WG9112340021	齿圈支架总成	Bracket	4	
63	WG680340015	止推垫圈	Ring	4	
65	WG680340016	调整垫片	Shim	2	
67	WG680340017	调整垫片	Shim	2	
69	WG680340018	调整垫片	Shim	2	
71	WG680340019	调整垫片	Shim	2	
73	WG680340186	调整垫片	Shim	2	
75	WG680340187	调整垫片	Shim	2	
80	WG9012340005	太阳轮 (Z=23)	Helical gear	4	
82	WG9012340076	太阳轮垫圈	Washer	4	
84	WG9231340223	半轴 (左)	Drive shaft -left	2	
86	WG9231340224	半轴 (右)	Drive shaft -right	2	

4.05 后桥轮辋及制动器/Driving axle rim and brake

ST16 轮辋及制动器

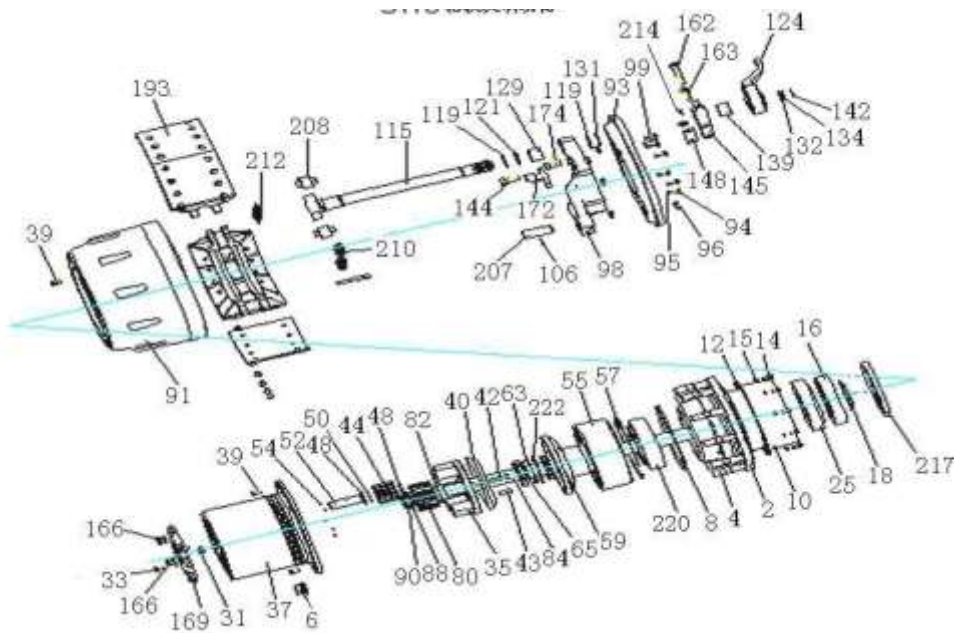

4.05 后桥轮辋及制动器/Driving axle rim and brake

序号 No.	零部件图号 Part No.	名称	Part Name	数量 Qty	备注 Remark
88	WG880 410097	垫圈	Washer	4	
90	190003933351	轴用弹性挡圈	Circlip	4	
91	WG9112340006	后制动鼓	Brake drum	4	
93	199112340012	制动器防尘罩	Brake cover	4	
94	Q150B0816	六角头螺栓	Screw	24	
95	Q40308	弹簧垫圈	Spring washer	24	
96	WG880340037	密封圈	Washer	16	
98	AZ9231340562	制动底板	Brake plate	4	
99	WG9112340010	ABS传感器输出保护套	Protect rubber	4	
106	Q5280624	弹性园柱销	Cylinder pin	8	
115	WG9231340226	制动凸轮轴(左)	Brake camshaft -left	2	
117	WG9231340227	制动凸轮轴(右)	Brake camshaft -right	2	
119	WG880440010	附加垫片	Washer	8	
121	WG880340023	O形密封圈	O-ring	4	
124	WG9100340056	间隙调节臂总成(左)	Adjusting device left	2	
127	WG9100340057	间隙调节臂总成(右)	Adjusting device right	2	
129	WG9100340017	复合衬套	bush	8	
131	190003933300	轴用弹性挡圈	Circlip	4	
132	WG880340022	垫圈	Washer	4	
134	WG80 320028	调整垫圈	Shim	2	

4.05 后桥轮辋及制动器/Driving axle rim and brake

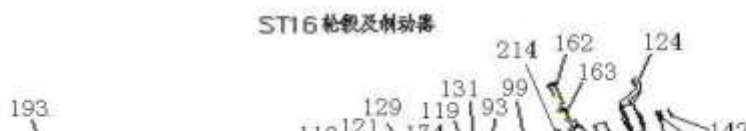

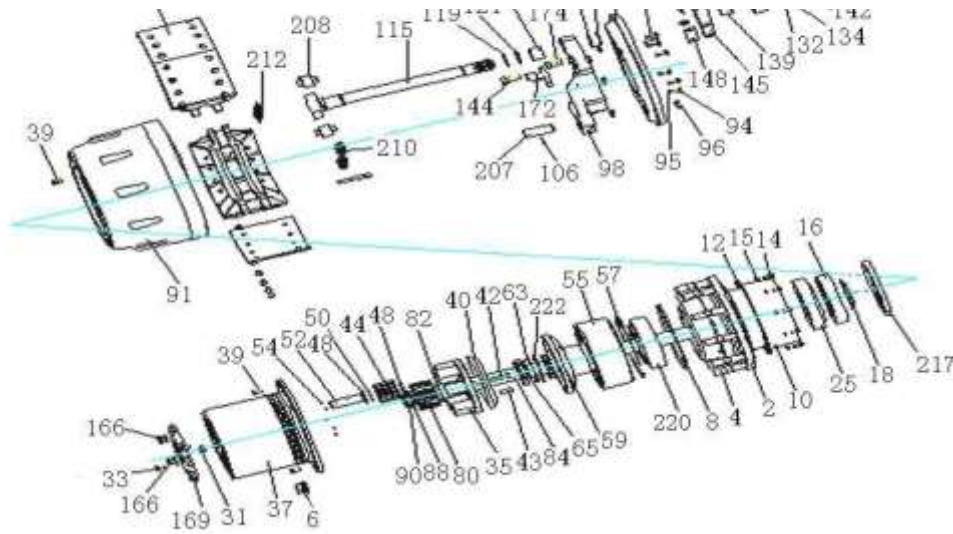

4.05 后桥轮辋及制动器/Driving axle rim and brake

序号 No.	零部件图号 Part No.	名称	Part Name	数量 Qty	备注 Remark
136	WG80 320029	调整垫圈	Shim	2	
138	WG80 320030	调整垫圈	Shim	2	
140	WG80 320046	调整垫圈	Shim	2	
142	190003933116	轴用弹簧档圈	Circlip	4	
143	Q151B1635TF2	六角头螺栓	Screw	32	
144	Q151B1645TF2	六角头螺栓	Screw	8	
145	199014340041	凸轮轴支架	Bracket	4	
148	WG880340031	调整垫片	Shim	2	
150	WG880340032	调整垫片	Shim	2	
152	WG880340033	调整垫片	Shim	2	
154	WG880340034	调整垫片	Shim	2	
156	WG3809470031	调整垫片	Shim	2	
158	WG3809470032	调整垫片	Shim	2	
160	WG3809470033	调整垫片	Shim	2	
162	Q151B1490	六角头螺栓	Screw	4	
163	Q151B1445	六角头螺栓	Screw	4	
166	WG9231340002	圆柱头内六角螺塞总成	Screw	8	
169	WG9231340001	端盖	Cover	4	
172	AZ9231340556	ABS传感器支架	Bracket	4	
193	AZ9231340200	制动蹄带衬片总成	Brake shoe ass.	8	

4.05 后桥轮辋及制动器/Driving axle rim and brake



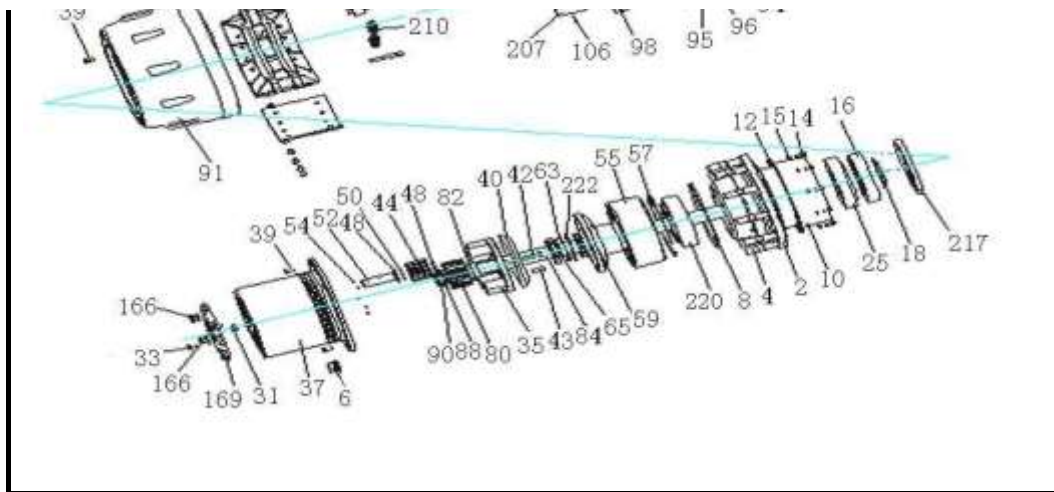

4.05 后桥轮辋及制动器/Driving axle rim and brake					
序号	零部件图号	名称	Part Name	数量	备注
No.	Part No.			Qty	Remark
194	AZ9231340203	制动蹄总成	Brake shoe	8	
204	WG9200340068	斯太尔制动摩擦片	Brake lining	16	
206	WG9231340068	铆钉	Rivet	128	
207	199000340064	支销	Pin	8	
208	WG9000340027	滚轮	Roller	8	
210	WG9231342015	回位弹簧	Spring	4	
212	WG9112340049	回位弹簧	Spring	8	
214	AZ9003963030	滑脂嘴总成	Grease nipple	4	
217	WG9981340113	轴密封圈	Gasket	4	
219	Q5003220	开口销	Split pin	2	
220	WG9981032222	圆锥滚子轴承	Roller bearing	4	
222	WG9231340034	止推垫环	Ring	4	